

REGMATIC

5/2 Way Namur Mount Solenoid Valve Series 20

| Figure No | Voltage |
|-----------|----------|
| 20024AC | 24 V AC |
| 20110AC | 110 V AC |
| 20220AC | 220 V AC |
| | |
| 20024DC | 24VDC |
| 20048DC | 48 V DC |
| 20110DC | 110 V DC |

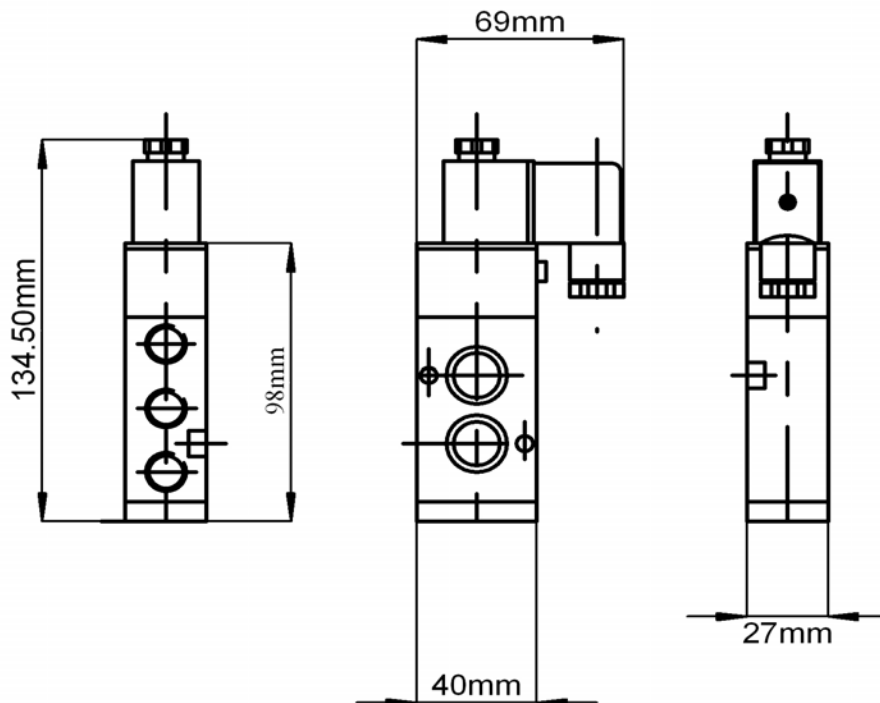

Technical data:

Protection class IP 65
Relative duty cycle 100 %
Voltage tolerance +/-10 %

Working pressure 1.5-8Bar
Area / Flow coefficient 14 mm², cv = 0.78
Power consumption AC = 5.5 VA, DC = 4.8 W

Approvals by ATEX, CSA and UL

Can also be supplied with coils for EEx ia 11 T6 and T4 and
EEx m 11 T4

COTSWOLD VALVES LTD.

Unit 27 Upper Mills Est , Bristol Road
Stonehouse . GLOS . GL10 2BJ . UK
Tel. 01453 826612 Fax 01453 827505
sales@cotswoldvalves.co.uk